



RuggON PX501 tablet Docking Quick Guide

1. Introduction

PX501 must be properly installed according to the following instructions.

T3RRA Mounting Kit Package includes:

- Tablet docking x 1
- VESA mount x 1
- Docking screw x 4
- Plate screw x 4
- Tie Cable x 2



NOT INCLUDED: *RAM VESA Plate with Ball option:* We recommend using the universal RAM-mount kit with the 100mm*100mm VESA holes and 2.25" ball to provide a stable mounting solution that makes operating the control buttons on the touch screen easier.

<https://rammount.com/products/ram-d-246u>



RAM® 100x100mm VESA Plate with Ball -
D Size
RAM-D-246U

2. Installation

- ① Before attaching, ensure the direction of the vehicle docking and RAM plate are correct.

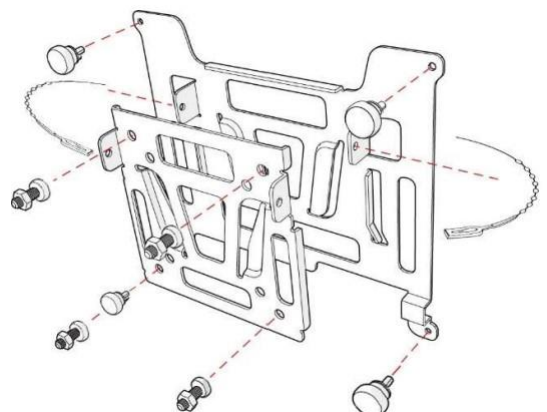

- ② Attach the vehicle docking plate to the back side of the PX501 tablet using the 4 provided docking screws.

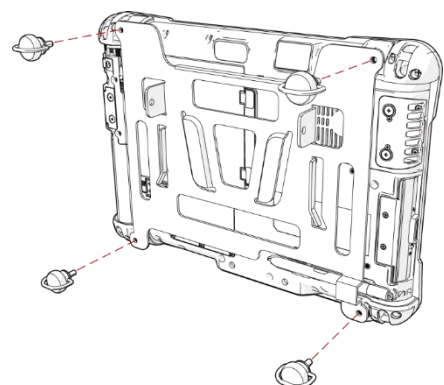

- ③ Attach the RAM plate to RAM VESA plate using the 4 provided plate screws.

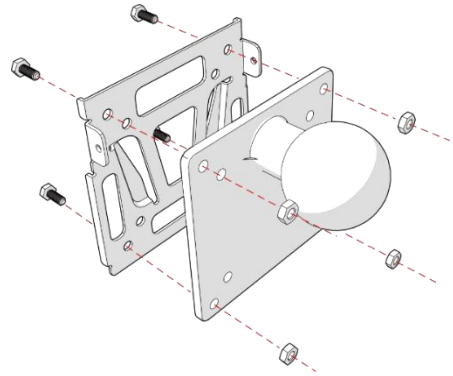

- ④ Put the RAM plate on the vehicle docking plate attached to the PX501 tablet.

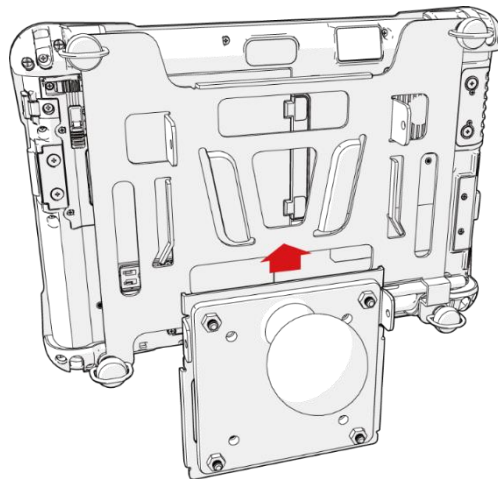

- ⑤ Put the Tie Cables on the RAM plate to secure it.

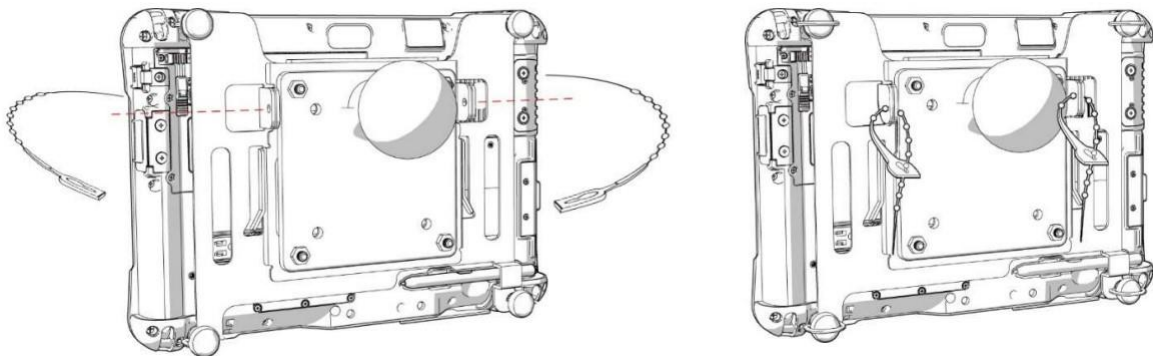

NOTE: Recommended mount is with a corner post bracket developed for a 4640 JD screen.

Other Mounting Options:

<https://www.rammount.com/part/RAM-246U>

1.5" ball



**RAM® 100x100mm
VESA Plate with Ball**
RAM-246U
Qty: 1

CommandARM™ options from John Deere

CommandARM™ console bracket



BRE10501 CommandARM bracket



RE576490 38.1-mm (1.5-in.) ball mount on 10-mm (0.4-in.) stud



PF80459 117.6-mm (4.63-in.) tie-rod assembly

Headliner mounting rail options from John Deere



R558980 mounting rail (shown with additional accessories for monitor and tablet)



BRE10483 38.1-mm (1.5-in.) T-slot ball mount assembly



PF80459 117.6-mm (4.63-in.) tie-rod assembly